

REV.	DESCRIPTION OF REVISIONS	APPR.	DRAW.	RELEASE	DATE
X1					
X2					

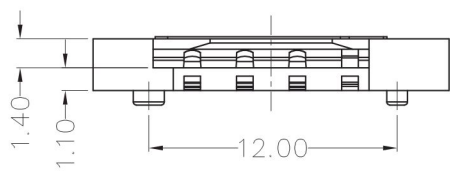
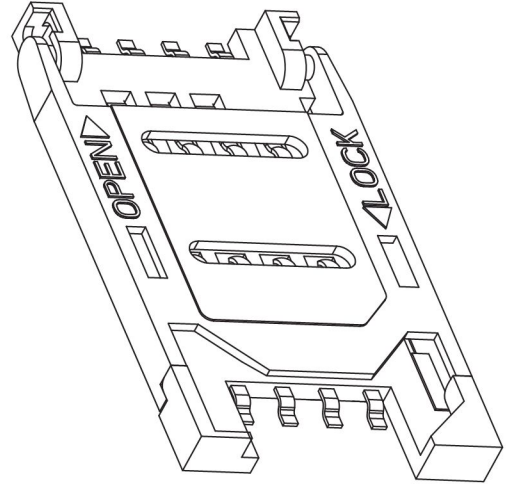
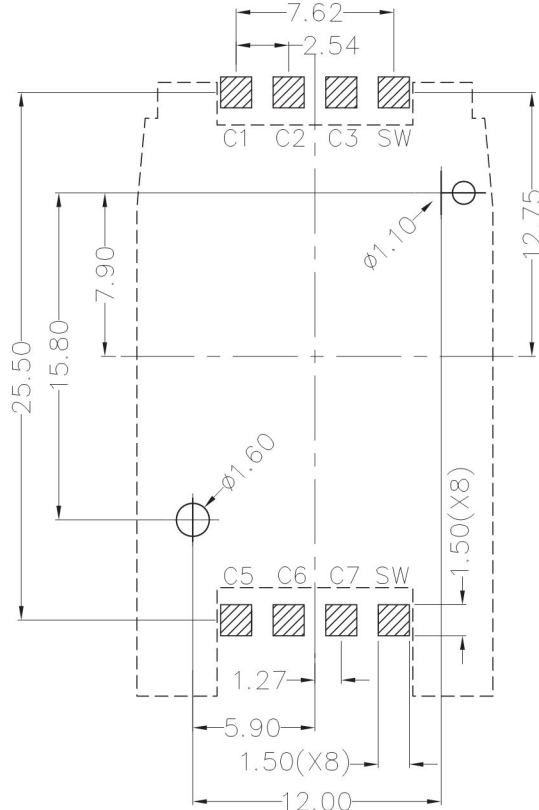
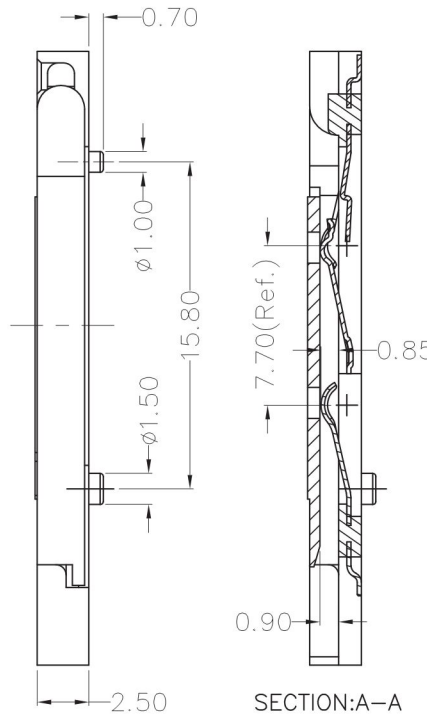
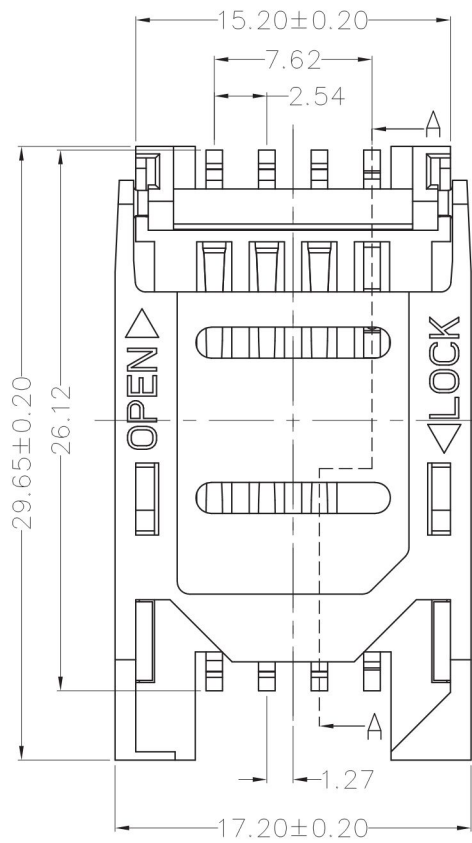

TECHNICAL CHARACTERISTICS

1.General Characteristics
 Dimensions: 29.65LX17.20WX2.50H mm
 Weight: Approx1.20g
 Durability: 5,000 cycles min.

2.Electrical Characteristics
 Contact resistance: 50mΩ typical,100mΩ max
 Insulation resistance: >1000MΩ/500V DC

3.Solderability
 Vapor phase: 215°C,30sec.Max
 IR reflow: 250°C,5sec.Max
 Manual soldering: 370°C,3sec.Max

4.Environmental Characteristics
 Operating temperature: -40°C~+85°C
 Operating humidity: 10%~+95%RH

ELECTRIC FUNCTION	DETECT SWITCH
WITHOUT CARD	OPEN
CARD INSERTED	CLOSED



ITEM	PART NAME	Q'TY	MATERIAL	FINISH
1	BASE	1	Hi-temp Thermoplastic	Black UL94V-0
2	COVER	1	Hi-temp Thermoplastic	Black UL94V-0
3	DATA CONTACT	6	Copper Alloy	Contact area:Gold plated
4	SWITCH CONTACT 2	1	Copper Alloy	Contact area:Gold plated
5	SWITCH CONTACT 1	1	Copper Alloy	Contact area:Gold plated

Unless otherwise specified, other tolerance are:			NAME: Smart Card Acceptor	
X ±0.35	X' ±5'	MODEL NO:		
X.X ±0.25	X.X' ±4'	TYPE: post optional		
X.XX ±0.15	X.XX' ±3'	PROJ.:	UNIT: mm	SCALE: 1:1
X.XXX ±0.10	X.XXX' ±2'	APPROVAL:	Simon Jan.15.2010	DWG NO.: 703-003
CUSTOMER DRAWING			SHEET: 1/1	REVISION: X1

